



TECH-TRAN CORP

RANCOCAS, N.J.

[300] KVA TRANSFORMER [3] PHASE [60] HZ
 CLASS [220] [150] °C RISE [3.7] %/ AT [120] °C
 SPEC. NO [22473] SER. NO [] WT [3600] LB

DE-ENERGIZE BEFORE CHANGING TAPS
 VOLTS CONNECT AMPS

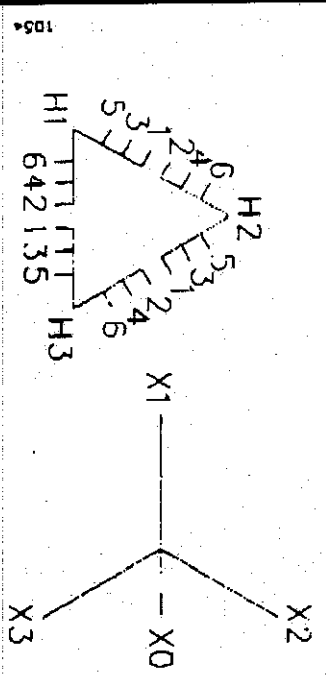

PR	1-2	12.0
14145	2-3	12.3
3800	3-4	12.6
3455	4-5	12.9
3110	5-6	13.2
SEC	480	361

1/4 TYP.
 1/4 TYP.

(4) 1/8" DIA. HOLES
 MATL: .030 ETCHED ALUM.
 FINISH: PMS#299 BLUE

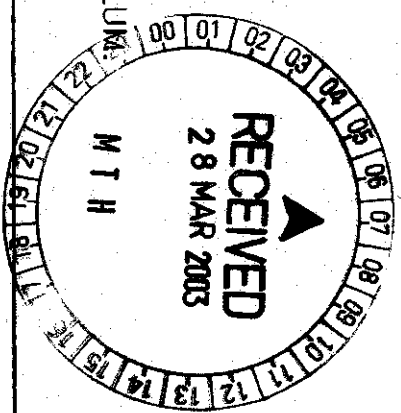

2	MKS	7-20-90	REDRAW
DRWN BY	DATE	TITLE	
MKS	7-20-90	NAMEPLATE	
CHECKED BY	SCALE	DWG. NO.	REV.
FULL		1054	2
		TECH-TRAN CORPORATION RANCOCAS, N.J.	
DI	DATE	DESCRIPTION	

NO.	REV.	DATE	REVISIONS	DESCRIPTION

TECH-TRAN CORPORATION, RANJICAS, N.J. 08073
 (609) 257-6750
 FAX/(609) 267-5751

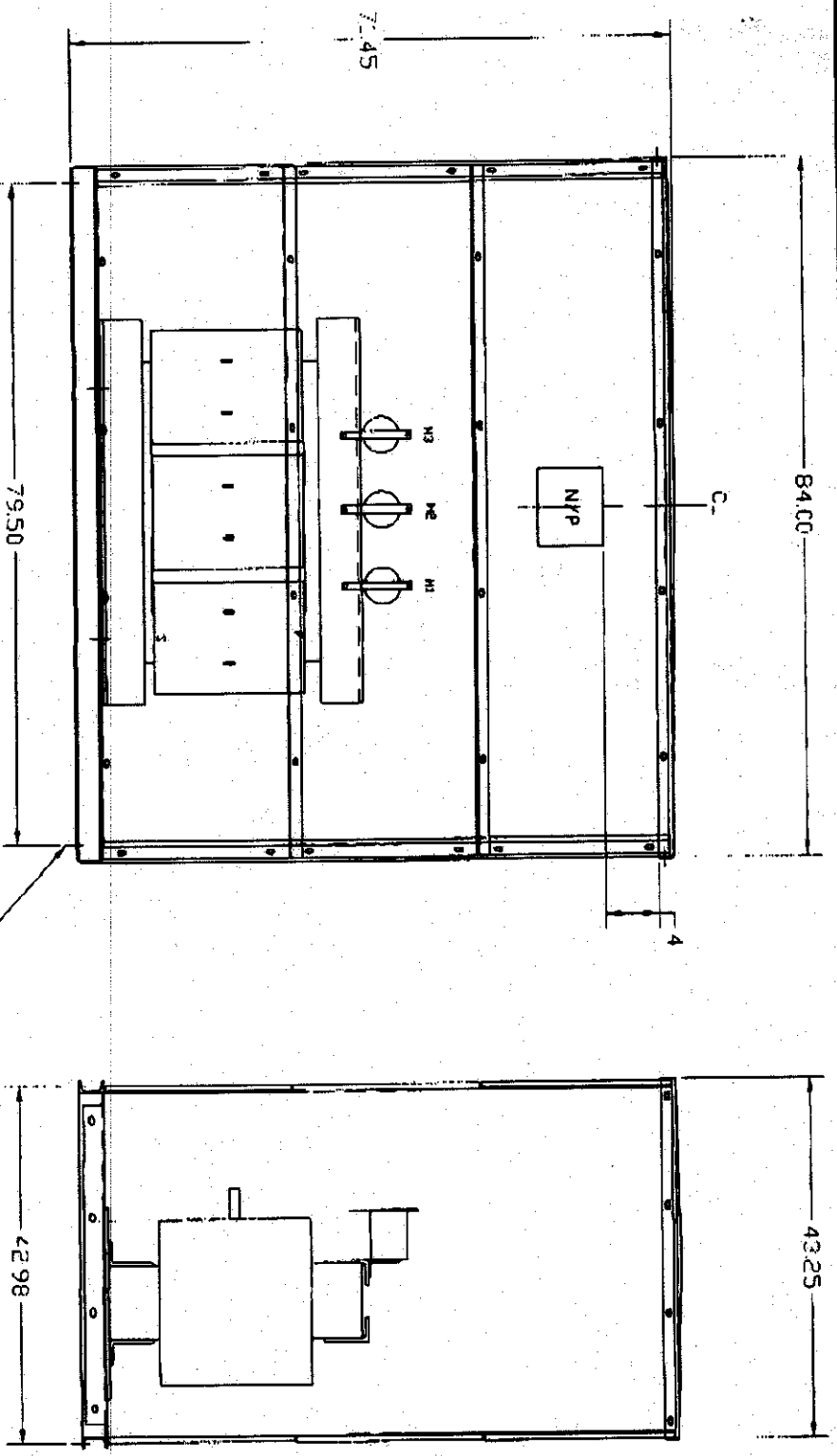

300 KVA, 3PH, 60HZ
 PR: 3.800 D W/2) 25% FCAN 434
 SEC 48C Y
 150C RISE 223 INSULATION
 NEMA 4 ENCLOSURE
 WEIGHT: 3500 LBS

WTR OUTLINE - JR 022473

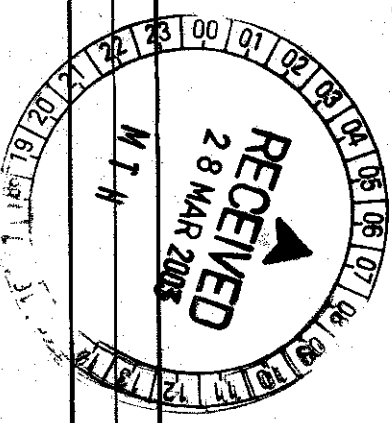

DATE	DESIGN	SCALE	DWG. NO.	REV.
3-15-05	YAA		22473-03	0C